

# S6287SLM/PLM

2011-2016 FORD F-250/350/450,  
6.7L POWERSTROKE,  
CREW CAB & SUPERCAB, 4" DPF BACK,  
SINGLE SIDE

# MBRP®

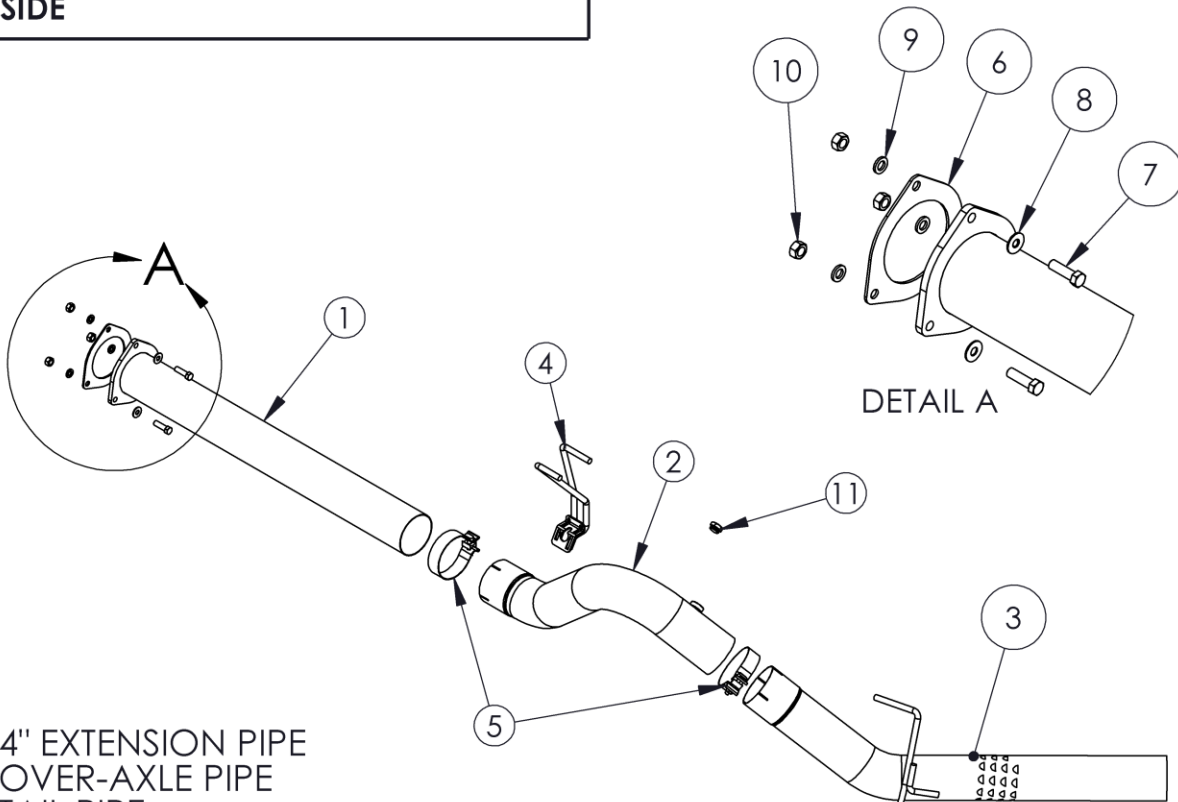

1. 4" EXTENSION PIPE
2. OVER-AXLE PIPE
3. TAIL PIPE
4. HANG TIGHT™ HANGER
5. 4" BAND CLAMP
6. FLANGE GASKET
7. 7/16" HEX BOLT (3PCS)
8. 3/8" WASHER (3PCS)
9. 7/16" LOCK WASHER (3PCS)
10. 7/16" HEX NUT (3PCS)
11. HEX HEAD PLUG

## PLEASE READ BEFORE STARTING INSTALLATION

**While MBRP has made every effort to ensure that all components of this system are of superior quality and properly packaged, it is the installer's responsibility to ensure the following before removal of the factory exhaust:**

- that ALL components shown above are present.
- that ALL mating components fit together.
- that there are no damaged components.
- that the system you have purchased is appropriate for your vehicle year, model and configuration.
- that the system will not interfere with any modifications previously installed or planned.
- that you have read and understand these instructions.

If you have any questions or are uncertain about any aspect of the installation of this system to your vehicle please contact your dealer before commencing installation.

## Removal of stock system:

1. Apply a penetrating lubricant liberally to all exhaust fasteners, hangers and rubber insulators.
2. Loosen the three (3) nuts securing the extension pipe flange to the over-axle pipe
3. Remove the temperature sensor from the over-axle/tail pipe. Remove the factory over-axle/tail pipe.
4. Loosen the three (3) nuts securing the extension pipe to the flange directly behind the exhaust filter and remove the extension pipe.

## Installation of MBRP Performance Exhaust:

1. The **Extension Pipe** is pre-cut for the 172.4" (crew-cab long-box) wheelbase. Cut the **Extension Pipe** to the appropriate length for the installation vehicle.

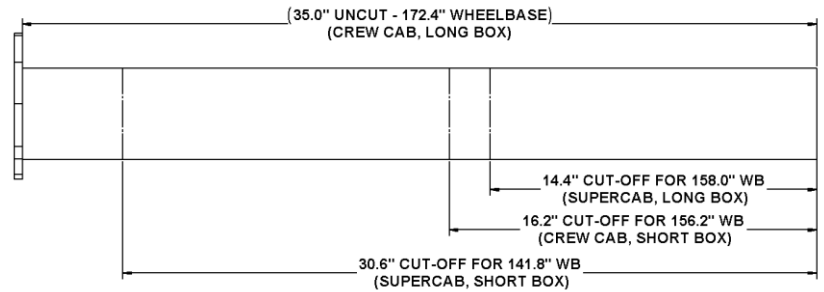

2. Mate the **Extension Pipe** flange to the stock exhaust flange with the **Flange Gasket** between them and fasten the flanges together with the hardware provided.

3. Install the **Hang Tight™ Hanger** onto a **4.0" Band Clamp** using the procedure shown below. (Hang Tight™ Hanger not exactly as shown)

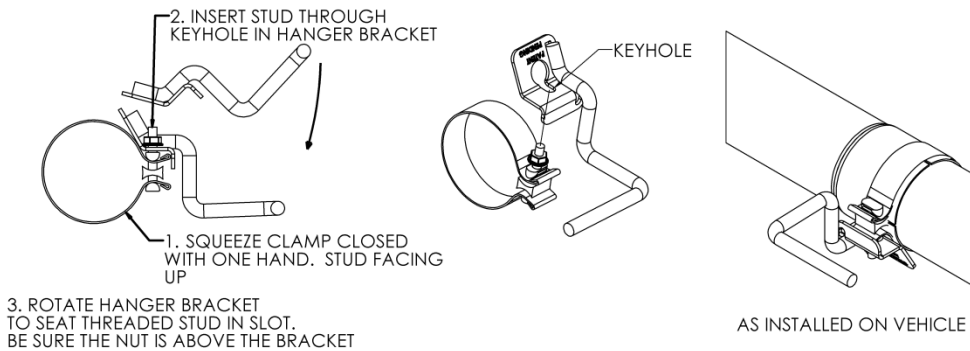

4. Place the previously assembled **Hang Tight™ Hanger** onto the end of the **Over-Axle Pipe**, leaving the clamp loose. Install the **Hang Tight™ Hanger** into the factory rubber isolators.
5. Place the second band clamp loosely onto the **Tail Pipe** and install onto the **Over-Axle Pipe**, inserting the hanger into the rearward factory rubber isolator.
6. Align the exhaust as required and tighten all connections.
7. Fasten the temperature sensor to the bung on the **Over-Axle Pipe** or install the supplied hex head plug (2011-2014 models).
8. Ensure that there is adequate clearance around the spare tire or any fuel and brake lines.

**Congratulations!** You are ready to begin experiencing the improved performance and driving excitement of your **MBRP** performance exhaust system. We know you will enjoy your purchase.