



## INSTALLATION INSTRUCTIONS

# REAR FACING LIGHTS



**\*THESE INSTRUCTIONS ARE FOR THE FOLLOWING LIGHTS:  
(2) REAR FACING SR-M®, (2) REAR FACING SR-Q®, (2) REAR FACING D-SERIES®**

### **IMPORTANT**

**THANK YOU FOR PURCHASING RIGID PRODUCTS FOR YOUR VEHICLE.**  
Please read through all of these Instructions and tips before proceeding with the installation.  
We do our best to provide a simple installation process for all applications however  
a professional installation is always recommended.

**Always disconnect any power sources connected to your vehicle  
before servicing fuses or electrical systems.**

## REAR FACING SR-M SERIES

Assemble your LED light kit by attaching the mount (D) to the housing (A) using the provided bolt(s) (B) and nylon lock nut(s) (C). Tighten until snug. Use the remaining bolt, washers, and nut (E, F, G, H) to mount the completed light assembly. A 5/16" hole is required. (See Figure Below)



## REAR FACING SR-Q SERIES

Assemble your LED light kit by attaching the mount (D) to the housing (A) using the provided bolt(s) (B) and nylon lock nut(s) (C). Tighten until snug. Use the remaining bolt, washers, and nut (E, F, G, H) to mount the completed light assembly. A 5/16" hole is required. (See Figure Below)



## REAR FACING D-SERIES

Assemble your LED light kit by attaching the mount (D) to the housing (A) using the provided bolt(s) (B) and nylon lock nut(s) (C). Tighten until snug. Use the remaining bolt, washers, and nut (E, F, G, H) to mount the completed light assembly. A 5/16" hole is required. (See Figure Below)



# WIRING INSTRUCTIONS

## IMPORTANT

Always disconnect the vehicle battery terminals before servicing the electrical system



1. When routing wire harness through any metal surface be sure it is free of any sharp edges and protected using wire sheathing or a grommet.
2. Route the harness through vehicle, connect the Rear Facing lamps by directly plugging into the Deutsch connector's that are pre-terminated onto the harness.
3. Route the switch lead of the harness to the desired switch location and follow the wiring diagram to ensure proper connections at the switch.
4. Connect the positive and negative battery terminals once all connections have been made with the RED harness lead connected to the positive battery terminal and the BLACK wire to the negative battery terminal.
5. Test to verify functionality, be sure to properly aim your new Rear Facing lighting before final torque on all mounting hardware.
6. If connecting to an existing switch be aware of the current rating of your selected switch, if switch rating is less than the amperage required to power your lighting then a relay must be added in line to prevent failure of the switch.
7. If connecting to existing wiring, make sure to use appropriate fusing and wire gauge. Be sure to use heat shrink tubing on all connections to ensure a weather tight seal.

# SWITCH WIRING

NOTE: 3/4" mounting hole required

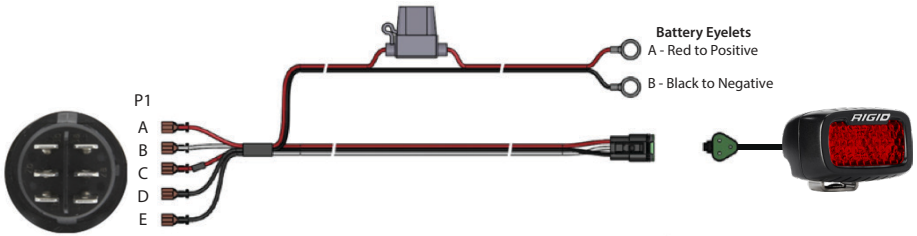

## SWITCH WIRING (SINGLE AND SETS)

- P1-A (Red Wire) on the Harness connect to 2A on the switch
- P1-B (Red & White Wire) on the Harness connect to 3A on the switch
- P1-C (Red Wire with Black Heat Shrink) on the Harness connect to 1A on the switch
- P1-D (Black Wire With Red Stripe) on the Harness connect to 1B on the switch
- P1-E (Black Wire) on the Harness connect to 3B on the switch

**Wiring: Wire your lights according to the instructions included with the light.  
Take care to avoid any heat sources and sharp or abrasive surfaces.**

# SR-M MOUNTING TEMPLATE

Measurements are in Inches

WHEN PRINTING:

PRINT 100% ACTUAL SIZE

DO NOT SIZE TO FIT

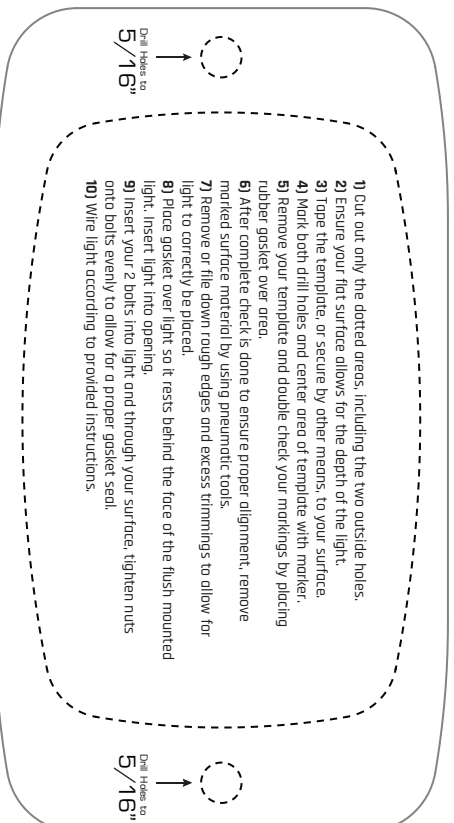

- 1) Cut out only the dotted areas, including the two outside holes.
- 2) Ensure your flat surface allows for the depth of the light.
- 3) Tape the template, or secure by other means, to your surface.
- 4) Mark both drill holes and center area of template with marker.
- 5) Remove your template and double check your markings by placing rubber gasket over area.
- 6) After complete check is done to ensure proper alignment, remove marked surface material by using pneumatic tools.
- 7) Remove or file down rough edges and excess trimmings to allow for light to correctly be placed.
- 8) Place gasket over light so it rests behind the face of the flush mounted light. Insert light into opening.
- 9) Insert your 2 bolts into light and through your surface, tighten nuts onto bolts evenly to allow for a proper gasket seal.
- 10) Wire light according to provided instructions.

# SR-Q MOUNTING TEMPLATE

Measurements are in inches

WHEN PRINTING:

PRINT 100% ACTUAL SIZE

DO NOT SIZE TO FIT

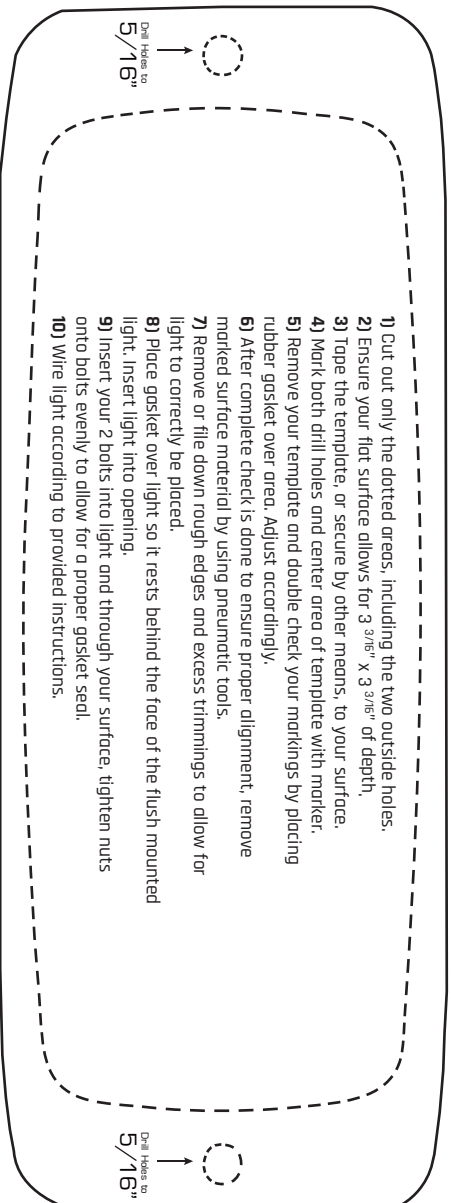

# SR-Q MOUNTING TEMPLATE

Measurements are in Inches

WHEN PRINTING:

PRINT 100% ACTUAL SIZE

DO NOT SIZE TO FIT



- 1) Cut out only the dotted areas, including the two outside holes.
- 2) Ensure your flat surface allows for  $3 \frac{3}{16}''$  x  $3 \frac{3}{16}''$  of depth.
- 3) Tape the template, or secure by other means, to your surface.
- 4) Mark both drill holes and center area of template with marker.
- 5) Remove your template and double check your markings by placing rubber gasket over area. Adjust accordingly.
- 6) After complete check is done to ensure proper alignment, remove marked surface material by using pneumatic tools.
- 7) Remove or file down rough edges and excess trimmings to allow for light to correctly be placed.
- 8) Place gasket over light so it rests behind the face of the flush mounted light. Insert light into opening.
- 9) Insert your 4 bolts into light and through your surface, tighten nuts onto bolts evenly to allow for a proper gasket seal.
- 10) Wire light according to provided instructions.



**Your installation is now complete.  
Welcome to the Rigid Nation!**

---

---

## **WARRANTY INFORMATION**

For warranty information, visit [www.rigidindustries.com/about/warranty](http://www.rigidindustries.com/about/warranty)

779 N Colorado St, Gilbert, AZ 85233 • 855-760-5337  
[www.rigidindustries.com](http://www.rigidindustries.com)

SR-M, SR-Q, D-Series, and Rigid Industries are registered and/or common law marks owned by JST Performance, LLC, a Delaware limited liability company d/b/a Rigid Industries.

11-12766-A